

RGBW Hand Remote Installation Guide

INSTRUCTION

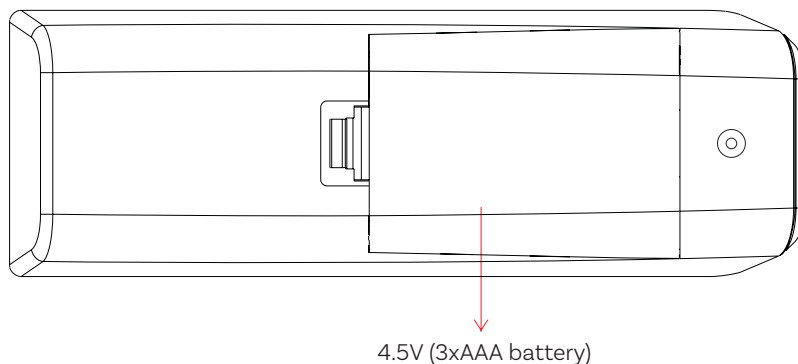
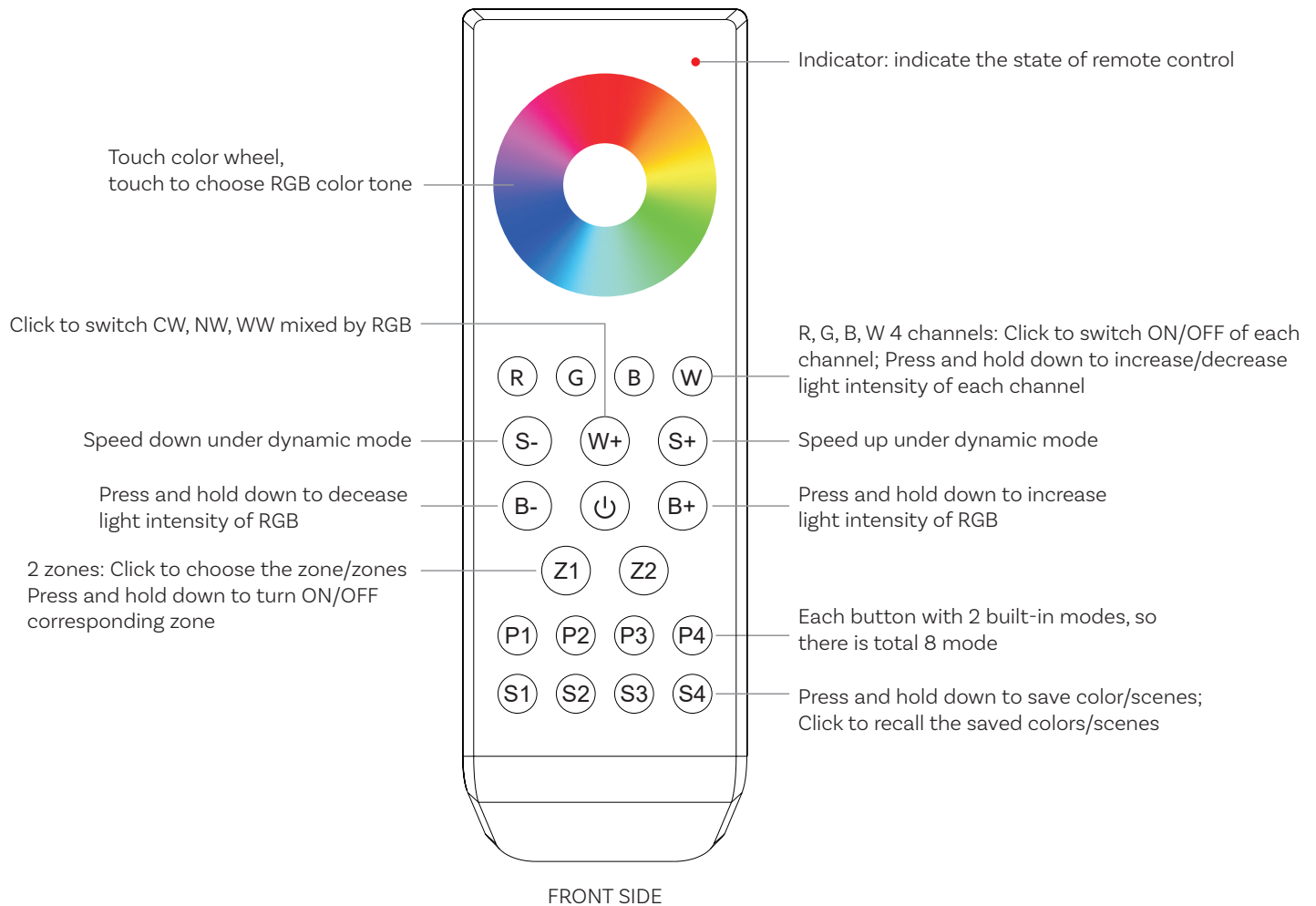

RGBW Hand Remote Installation Guide

PRODUCT DATA

Output	RF Signal
Operation Frequency	869.5 / 916.5 / 434MHz
Power supply	4.5V (3xAAA battery)
Operating Temperature	0 - 40°C
Relative humidity	8% - 80%
Dimensions	5.2" x 1.7" x 0.95"

- High sensitive & high stable touch color wheel, fast & precise color control.
- 8 changing modes. Enable to stay at any color under situation of color changing modes.
- Compatible with all universal series RF receiver
- 1 receiver can be paired by max 8 different remote control
- Waterproof grade: IP20

Safety & Warning

- This device contains AAA batteries that shall be stored and disposed properly
- DO NOT expose the device to moisture

PAIR WITH RF RECEIVER (METHOD 1)

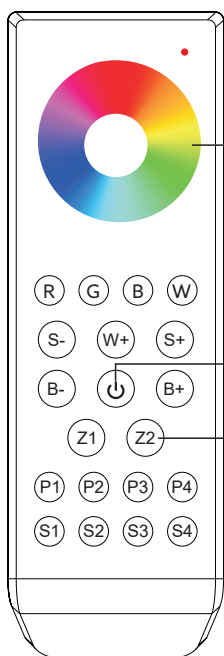

Step 1: Do wiring the RF receiver according to wiring diagram (please refer to the instruction of RF receiver that you would like to pair with)

Step 5: Touch the color wheel, LED lights connected with RF receiver flicker once means the receiver is paired with zone 4 successfully

Step 2: Click ON/OFF button to active the remote

Step 4: Choose and click a zone number (e.g. zone 4)



Step 3: Power off and power on the receiver

RGBW Hand Remote Installation Guide

PAIR WITH RF RECEIVER (METHOD 2)

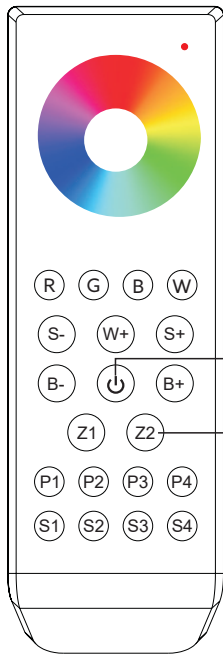

Step1: Do wiring the RF receiver according to wiring diagram
(please refer to the instruction of RF receiver that you would like to pair with)



Step 3: Power off and power on the receiver

Step 2: Click ON/OFF button to active the remote

Step 4: Choose and click a zone number (e.g. zone 4) twice, the press and hold it continuously and quickly with 10 seconds, LED lights connected with RF receiver flicker once means the receiver is paired with zone 4 successfully

SAVE COLOR/SCENE/MODE

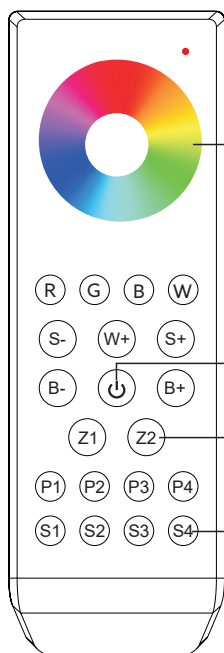

Step 3: Touch the color wheel or click the other buttons to select the scene you like

Step 1: Click ON/OFF button to active the remote

Step 2: Choose and click one or multiple paired zone numbers (e.g. zone 2)

Step 4: Press and hold any scene buttons of S1-S4(e.g. S4) , LED lights connected with the RF receiver flicker once means the color/scene was saved successfully.

RGBW Hand Remote Installation Guide

RECALL THE SAVE COLORS / SCENES

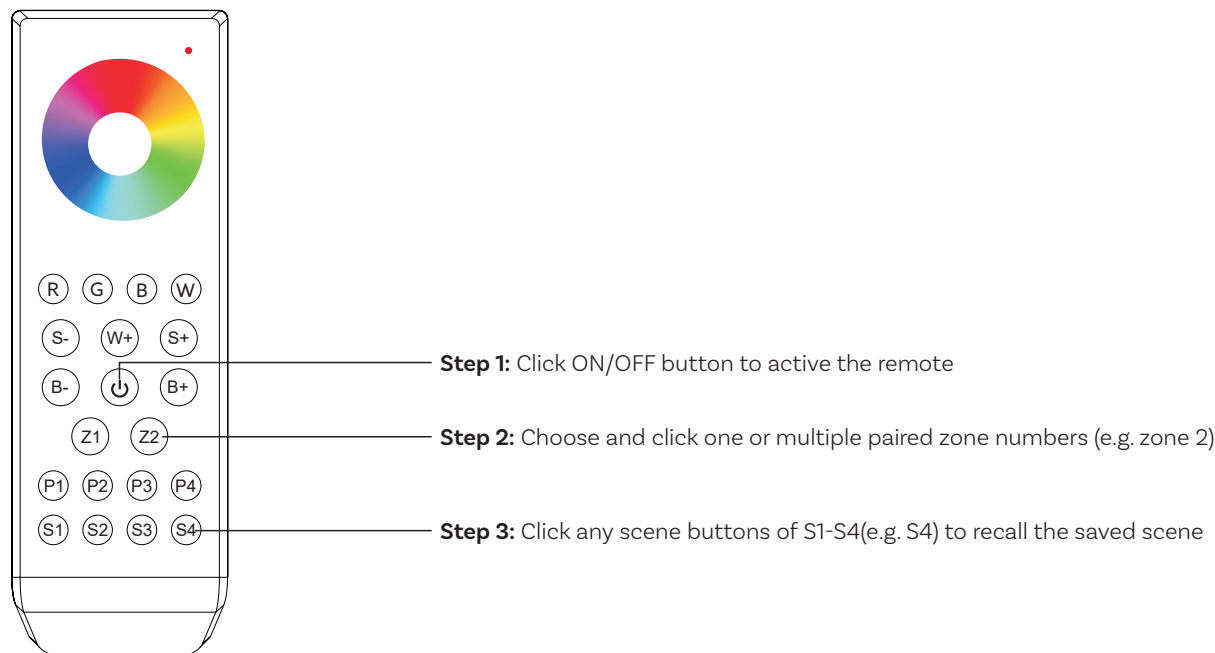

MULTIPLE RECEIVER

If you use multiple receivers, you have two choices

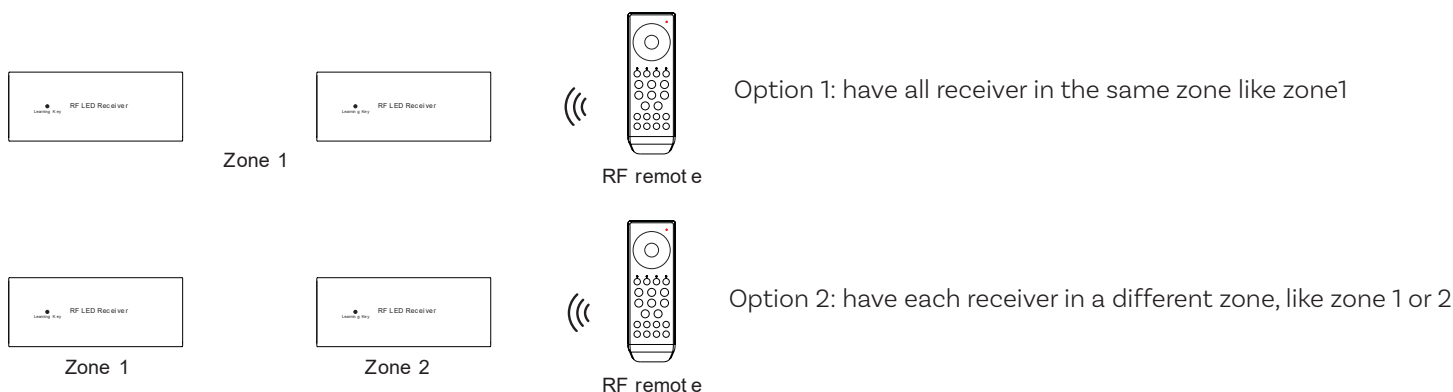

How to stop running mode of single color LED light caused by RGBW sender interference:

1. When pairing single color LED light to a single color remote, it might be interfered and paired by nearby RGBW sender, which might control the single color light in to running mode. The running mode can not be stopped by the paired single color remote by delete pairing.
2. Then we need this remote, and pair the remote to the receiver via above **Pair twith RF receiver (Method 2)**, the touch the touch the color wheel to stop the running mode
3. Then delete pairing and pair the receiver to the single color remote again, it can be controlled by the remote again